

Concrete Tiles

TECHNICAL DATA SHEET



Striata

SA

Modern concrete tiles are made from sand and cement with a pigmented colour coat. This can replicate the appearance of a broad array of distinctive tile designs, while remaining relatively cost-effective.

Acoustic Performance

The density of tiles helps reduce external sound such as aircraft and road noise and, particularly, rain and hail.

Thermal Performance

Roof tiles can help you enjoy more comfortable living in summer and winter. The thermal mass of concrete materials when used correctly can result in advantageous insulation properties, in addition to considerations such as sarking and overall solar design.

Widest range of colours and profiles

With up to 6 profiles and 13 colours to choose from, there's a tile that's just right for your home!

Economical

Our concrete tiles are priced to suit most budgets.

20 Year Warranty*

Concrete tiles are suitable for all environments, including marine and bushfire prone areas.

Specification Notes

Roofing material shall be Boral Concrete Striata SA *(Please specify a colour)* _____

Sarking shall be Boral Sarking Extra Heavy Duty

Product Specification



Striata



Plain View



Cross Section

| Striata - SA | | |
|-----------------------------|--|----------------------------------|
| Coverage | No of tiles per sq m | 10.80 (mean) |
| Dimensions (Nominal) | Actual length | 432mm |
| | Actual width | 315mm |
| | Exposed length | 342mm (mean) |
| | Exposed width | 280mm |
| Mass (Nominal) | Mass per tile | 5.3kg |
| | Mass per sq m | 55.33kg |
| Minimum Roof Pitch | 18° with sarking or 20° without sarking | |
| Set Out (Nominal) | Batten spacing | 342mm |
| First Course | Batten spacing | 315mm (using a 38mm wide batten) |
| Head Lap | Minimum head lap shall be 90mm. This may increase according to set out. However, head lap should not exceed 110mm. | |
| Recommended Bond | Cross Bond | |
| Availability | SA | |



Accessories

Ridge and Hip Tile

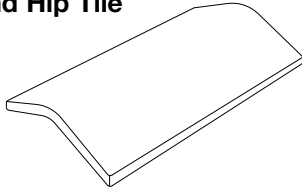

Standard Ridge (130°)
Dimensions: 430L x 250W x 85D
Cover length: 400

Barge Tile

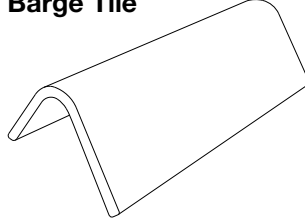

Barge Capping (76°)
Gable end cover tile
Dimensions: 430L x 220W x 140D
Cover length: 1 length per tile

Apex Tiles

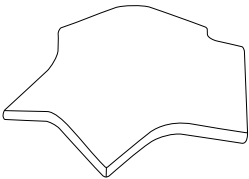

Three Way Apex (130°)
Dimensions: 430L x 440W x 85D

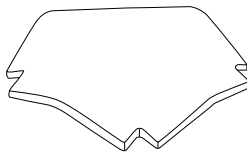

Four Way Apex (130°)
Dimensions: 370W x 140D

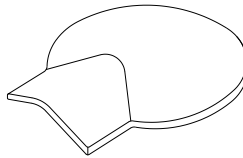

Spoon Apex
For closing multiple hip junctions
Dimensions: 515L x 435W x 110D

Additional Resources;
Boral Roofing Technical Design Manual boral.com.au/rooftiles
BIM Drawings boral.com.au/designlab

For more information about Boral's Roofing products call **1300 134 002** or visit boral.com.au/rooftiles

Important Information: Product information contained in this leaflet is correct at the time of printing however is subject to change without notice. *20 year limited warranty that the Concrete Roof Tiles are manufactured in accordance with Australian Standards Association AS 2049. The warranty will not apply if the roof tiles (a) have not been installed in accordance with AS 2050 (b) have been affected by colour change, shade variation or glaze weathering; or (c) have been damaged by roof traffic or chemical treatments, coating or cleaners or by falling items, pollution, storm or hurricane. Proof of purchase and other information required by Boral must be provided. See www.boral.com.au/roofing-masonry-terms-quotation-supply for full terms and conditions. Some photos featured in this brochure are artist's impressions of how Boral roof tiles will look on a roof. Some images are computer generated. Please ensure you view a tile display before making a final decision. Colours shown are indicative only and should not be used for final selection. Colours are subject to change without notice. Check print date prior to product selection. Roof tile colours may vary in shades throughout the manufacturing process therefore it is important that roof tiles are blended consistently across the roof. At Boral Roofing, all tiles are manufactured to the requirements of Australian Standard 2049 Roof tiles. Please ask for a copy of the Boral Roofing guarantee before making your purchase. During transportation and installation small blemishes such as scuffing and chip marks may occur. These are not considered a production fault and will not detract from the performance of the roof tile.
© Copyright Boral Roofing – all rights reserved 2018. Boral, the Boral logo, build something great, are trade marks or registered trade marks of Boral Limited and its subsidiaries. Boral Roofing ABN 34 002 944 694. Correct as at April 2018. BCC15598

